



Call for Art | Request for Qualifications

Washington State Arts Commission (ArtsWA) and
Department of Social and Health Services (DSHS)



Figure 1: aerial rendering of the new WSH Forensic hospital (courtesy HOK)

Project: Western State Hospital – First floor interior walls, New Forensic Hospital

Deadline: Tuesday, April 30th, 2024 at 4pm Pacific Time

Budget: \$800,000 (up to 3 artworks, inclusive of design, fabrication, installation & tax)

Description: This is an exciting opportunity for one or more artists/artist teams to create artwork for the first-floor interior of Western State Hospital's new forensic hospital, located in Lakewood, WA. The art selection committee seeks works that are calm, soothing and convey an uplifting message of hope and resilience. Artists with lived experience with mental illness are especially encouraged to apply.

Questions? Contact Adetola Abatan, Art in Public Places Project Manager, 360-468-0889, adetola.abatan@arts.wa.gov

Project Overview

Washington state's vision of transforming behavioral health includes constructing a therapeutically designed hospital on the Western State Hospital campus with 350 beds to care for forensic patients in a modern facility. The hospital will also serve as a Forensic Center of Excellence and focus on providing state-of-the-art care for forensic patients, since the new forensic hospital will serve patients who enter care through the criminal court system. The new hospital will operate in an environment of care that supports safety, the delivery of evidence-based proven practices, and working hand in hand with local academic institutions to support research and innovation.

The new forensic hospital is designed to have three zones by level:

- **Home:** upper four floors, patient units/residences. Designed with soft and subtle colors.
- **Neighborhood:** these sectors are attached to the home units and include dining, classrooms, and treatment rooms
- **Downtown:** patients gain access to this area over time. It is designed to encourage normalized behavior, and includes amenity spaces like a gym, movement rooms for yoga, a library, a barber shop, non-denominational chapel, a café, and visitation areas.

The 'downtown' area presents an opportunity for one to three, multi-story wall mounted artwork(s) that extend along the downtown corridor. Design features include natural Douglas Fir wall and ceiling treatments, polished concrete, and shades of green that align with the design theme of an urban park, while also honoring the natural beauty of the Pacific Northwest. The schematic below shows the potential art locations.

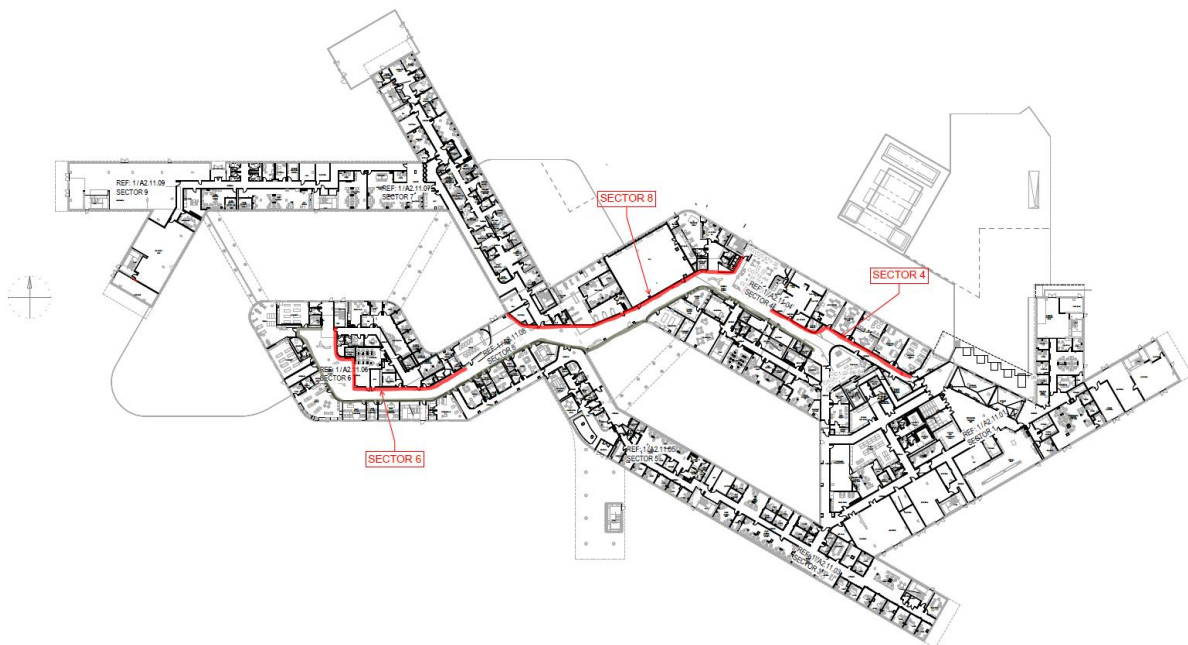

Figure 2: schematic of the 3 artwork zones on the first-floor north corridor (courtesy HOK)



Figure 3: interior rendering to illustrate design themes (near multifaith chapel, courtesy HOK)

Call for Art

We seek artists or artist teams who have lived experience with mental illness¹ to design and create artwork for the first-floor interior of Western State Hospital's new forensic hospital. Lived experience with mental illness can be firsthand experience, experience through someone you know, or experience through people or communities you've worked with. The chosen artist(s) should be able to design artwork that is culturally sensitive and considerate of the patient experience.

The committee seeks peaceful artwork to aid recovery. Artworks should be calm, soothing and convey an uplifting message of hope and resilience. The committee is interested in artworks that enhance the interior downtown corridor's design theme or "urban park" which utilizes Douglas Fir wood paneling and subtle shades of green and blue.

Potential materials and artworks could include:

- Applied wall coverings
- Solid surface painted panels
- Impact resistant glazing
- Environmental graphics

¹ The committee is looking for an artist that will be able to understand and relate to their patient population, and sensitively design artwork for them with awareness. Knowing that this can be personal and sensitive, we are not encouraging anyone to share anything in their application that they'd be uncomfortable sharing. Applicants do not need to disclose personal health details. Simply stating you have experience, and how you might address creating artwork for this population to demonstrate your sensitivity should suffice.



Figure 4: interior rendering to illustrate design themes (cafe, courtesy HOK)

Artworks will need to adhere to strict patient safety criteria. Please reference the resource section at the end of these guidelines for more details on acceptable materials and trauma informed design.

Budget

\$800,000 is the total budget for up to three large-scale interior artwork(s). The artwork budget is inclusive of design, travel, structural engineering, materials, fabrication, installation, artist fee, taxes, and all other associated project costs.

Eligibility

You are eligible to apply if you:

- Live in the United States or British Columbia
- Are not enrolled as a visual arts student as of May 2024
- Do not have an active project with ArtsWA
- Are not a staff or Board member of ArtsWA, DSHS, or WSH

We do not discriminate based on race, sex, religion, color, national origin, age, ancestry, disability, or gender identity.

How to apply

Please prepare the items below and apply on [Submittable](#) by **4pm Pacific on Tuesday, April 30.**

- **Statement of interest** (limit 300 words) that outlines your approach to public art and summarizes your interest in creating artwork for the interior of Western State Hospital.

Describe your experience with similar projects. Include what differentiates you, including your lived experience with mental illness.

- **Brief biography or artist statement** (limit 300 words) that describes your background and path to being an artist. Artist teams may submit a statement for each member.
- **8 images of past works**, preferably from within the past 5 years
- **Brief descriptions (1-2 sentences) for each image.** Include title, dimensions, materials, date, location, budget/cost, and commissioning entity (if applicable).

Artists from Nisqually, Steilacoom, Puyallup, Cowlitz, Coast Salish, and/or the other tribes of the Pacific Northwest are encouraged to apply.

To avoid technical problems, please submit well in advance of the deadline. **We will not accept late applications.**

Art Committee

WSH's Interior Art Selection Committee consists of community members, staff, patients, administrators, and project architects. The committee will review applications and choose artist(s) or artist team(s) to design 1-3 artworks for the first-floor wall surfaces. The committee may decide to interview 2-3 finalists before making their selection. Upon design approval, the artist(s) will receive a commission contract to fabricate and install the work.

Selection Criteria

The Art Committee will consider whether your portfolio:

- Communicates a unique vision or perspective
- Shows a potential to engage or respond to its surroundings, or both
- Demonstrates technical skill and command in your chosen medium

They will also assess how each applicant's lived experience, art practice, and interests best match the artwork goals for the interior based on your statements. The Art Selection Committee may opt to not select an artist from this submission process.

Commission Process

If selected, you will:

- design an artwork proposal for review and approval by ArtsWA staff, conservator, structural engineer, and the art committee
- travel to the project site up to 3 times during the proposal/design process to meet with the Art Committee and ArtsWA project manager (meetings may be held remotely)
- meet with the building design team to coordinate artwork integration
- work within the stated project budget
- obtain registration as a state vendor and adhere to applicable state permitting and licensing requirements, including contracting and the paying of Prevailing Wages
- enter and fulfill the requirements of contracts with ArtsWA, and pay applicable taxes

ArtsWA will commission the artworks. They will become part of the State Art Collection. You'll coordinate installation through ArtsWA and DSHS/WSH. You can view sample [contracts here](#).

Timeline

- April 12, 2024: distribute RFQ
- April 30, 2024: applications due on Submittable
- May 2024: selected artist(s) notified
- Jun – Aug 2024: artist(s) site visit
- Aug – Dec 2024: design phase in collaboration with architects and design team
- Feb 2025 – Dec 2026: fabrication phase
- Mar – May 2027: anticipated artwork installation

Additional Resources & Materials

- [Trauma Informed Material & Design Guidelines](#)
- [New forensic hospital FAQ](#)
- [ArtsWA's Art Plan for the new forensic hospital](#)
- [ArtsWA's Public Artist Handbook](#)
- [ArtsWA's Material and Fabrication Handbook](#)

For additional information

- Adetola Abatan, AIPP² Project Manager, adetola.abatan@arts.wa.gov, 360-468-0889
- Lauren Iida, AIPP Project Manager, lauren.iida@arts.wa.gov, 360-485-1224
- Marissa Laubscher, AIPP Sr Project Manager, marissa.laubscher@arts.wa.gov, 360.252.9974

² The Art in Public Places (AIPP) program purchases and cares for artworks in state buildings, colleges, universities, and schools throughout Washington. AIPP is uniquely positioned to advance and support art and artists across the state. Our goal is to build and care for a State Art Collection that is impactful, accessible, and valued. We seek lasting artworks that reflect Washington's diverse communities.